

DO NOT SCALE
A1

File: CP1770-ATK-01-ZZ-M2-CE-0021-0024.dwg
Date: Jul 05, 2019 - 1:37pm
Plotted by: ENicMurchu

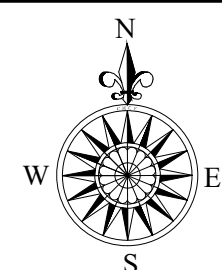
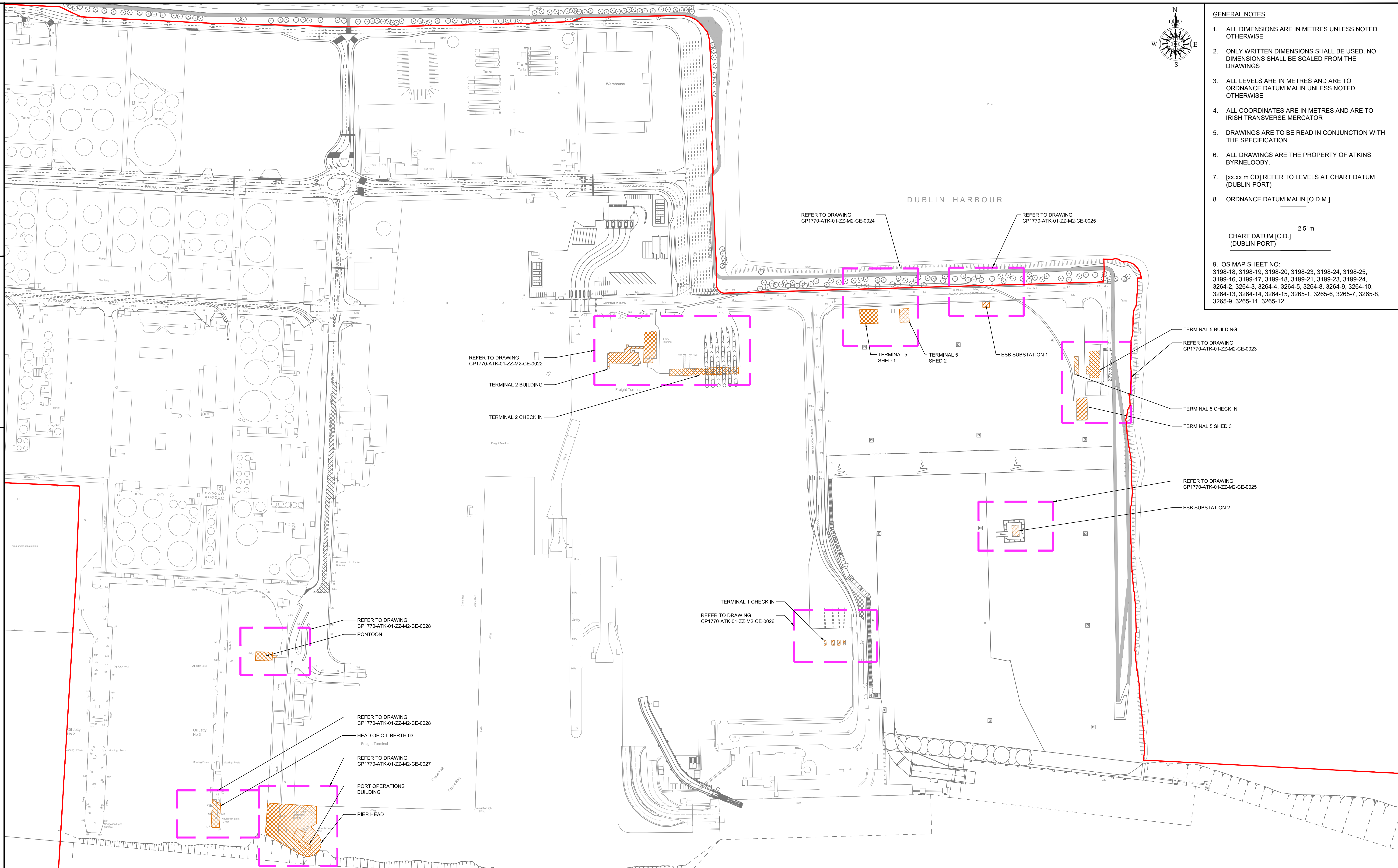

- GENERAL NOTES**
1. ALL DIMENSIONS ARE IN METRES UNLESS NOTED OTHERWISE
 2. ONLY WRITTEN DIMENSIONS SHALL BE USED. NO DIMENSIONS SHALL BE SCALED FROM THE DRAWINGS
 3. ALL LEVELS ARE IN METRES AND ARE TO ORDNANCE DATUM MALIN UNLESS NOTED OTHERWISE
 4. ALL COORDINATES ARE IN METRES AND ARE TO IRISH TRANSVERSE MERCATOR
 5. DRAWINGS ARE TO BE READ IN CONJUNCTION WITH THE SPECIFICATION
 6. ALL DRAWINGS ARE THE PROPERTY OF ATKINS BYRNELOOBY.
 7. [xx.xx m CD] REFER TO LEVELS AT CHART DATUM (DUBLIN PORT)
 8. ORDNANCE DATUM MALIN [O.D.M.]
- CHART DATUM [C.D.] (DUBLIN PORT) 2.51m
9. OS MAP SHEET NO:
3198-18, 3198-19, 3198-20, 3198-23, 3198-24, 3198-25, 3199-16, 3199-17, 3199-18, 3199-21, 3199-23, 3199-24, 3264-2, 3264-3, 3264-4, 3264-5, 3264-8, 3264-9, 3264-10, 3264-13, 3264-14, 3264-15, 3265-1, 3265-6, 3265-7, 3265-8, 3265-9, 3265-11, 3265-12.

ATKINS PROJECT No. : 5163122
 Ordnance Survey Ireland Licence No. AR0082519
 © Ordnance Survey Ireland/Government of Ireland

- APPLICATION BOUNDARY
 - PROPOSED STRUCTURES FOR DEMOLITION
- NOTE:
BACKGROUND MAPPING INDICATES EXISTING & CONSENTED LAYOUT

Rev	Description	By	Date	Chk'd	Auth
00	ISSUED FOR PLANNING	MOD	07.19	KH	AC

ATKINS
 Member of the SNC-Lavalin Group
BYRNELOOBY
 WS Atkins Ireland Ltd. & ByrneLooby Partners Ltd.
 Atkins House,
 150 Airside Business Park,
 Swords, Co. Dublin

Client
COMHLAUGHT CHALAFOR
ÁTHA CLIAH
DUBLIN PORT COMPANY

Project
MP2

Purpose		PLANNING			
Title		DEMOLITION PLAN OVERALL LAYOUT			
Original Scale	Design/Drawn	Checked	KH	Authorised	AC
1:2000 @ A1	MOD	Date 05.07.19	Date 05.07.19	Date 05.07.19	
Status	Drawing Number	Rev			
P	CP1770-ATK-01-ZZ-M2-CE-0021	00			